

LUNES 2.0 AH



BOX DOCCIA AD ANGOLO, APERTURA 2 ANTE SCORREVOLI E 2 FISSE
 ANTE SGANCIABILI PER UNA MIGLIORE PULIZIA

Misure			Codice	Sinistra Destra		Scelta vetro				Scelta profilo			
Misura effettiva d'ingombro		Entrata		S-	D-	1	2	11	78	A	B	K	J
A	F1	*				Trasparente	Aqua	Niva	Serigrafia Lunes 2.0	Bianco	Silver	Cromo	Argento
66 ↔ 69	33	36	LUNAH66L	S-	D-	●							
69 ↔ 72	34	38	LUNAH69L	S-	D-								
72 ↔ 75	36	39	LUNAH72L	S-	D-								
75 ↔ 78	37	41	LUNAH75L	S-	D-	●							
78 ↔ 81	39	42	LUNAH78L	S-	D-	●							
81 ↔ 84	40	44	LUNAH81L	S-	D-								
84 ↔ 87	42	45	LUNAH84L	S-	D-	●							
87 ↔ 90	43	47	LUNAH87L	S-	D-	●							
90 ↔ 93	45	48	LUNAH90L	S-	D-								
93 ↔ 96	46	50	LUNAH93L	S-	D-								
96 ↔ 99	48	51	LUNAH96L	S-	D-	●							
99 ↔ 102	49	53	LUNAH99L	S-	D-								
102 ↔ 105	51	54	LUNAH102L	S-	D-								
105 ↔ 108	52	56	LUNAH105L	S-	D-								
108 ↔ 111	54	57	LUNAH108L	S-	D-								
111 ↔ 114	55	59	LUNAH111L	S-	D-								
114 ↔ 117	57	60	LUNAH114L	S-	D-								
117 ↔ 120	60	60	LUNAH117L	S-	D-								
120 ↔ 123	63	60	LUNAH120L	S-	D-								
123 ↔ 126	66	60	LUNAH123L	S-	D-								
126 ↔ 129	69	60	LUNAH126L	S-	D-								
129 ↔ 132	72	60	LUNAH129L	S-	D-								
132 ↔ 135	75	60	LUNAH132L	S-	D-								
135 ↔ 138	78	60	LUNAH135L	S-	D-								
138 ↔ 141	81	60	LUNAH138L	S-	D-								
H 160 ↓ 200				SPECIAL		LUNAHLDSP				Destra			
						LUNAHLSPP				Sinistra			

PER COMPORRE UN ANGOLO ORDINARE 2 LATI

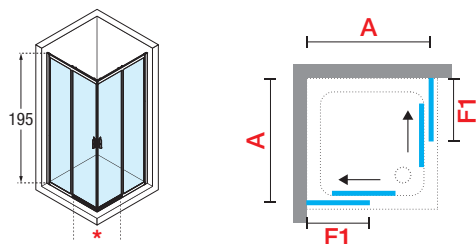

● Disponibilità indicativa deposito centrale 7gg.

Costruzione del codice Codice + Sinistra/Destra + Vetro + Profilo = Codice prodotto finale



DATI TECNICI

VETRO TEMPRATO 3, 4, 5, 6 mm (European standards UNI EN 14428)



Trasparente
COD. 1

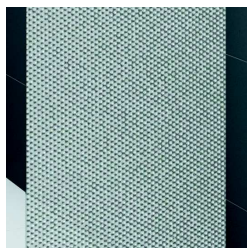

Niva
COD. 11



Aqua
COD. 2

SERIGRAFIA

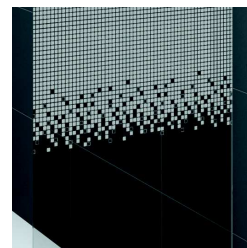

Lunes 2.0
COD. 78

FINITURA PROFILI



Bianco
COD. A



Silver
COD. B



Cromo
COD. K

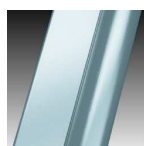

Argento
COD. J

MANIGLIA



Maniglia in metallo cromato

MISURE DI INGOMBRO PROFILI DI FISSAGGIO

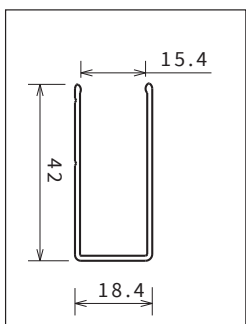

a muro
R-2A-2P-2PH-A-AH

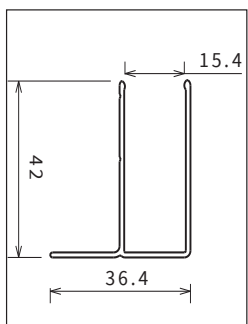

a muro
G+FL-3PH-3P-S-B-G

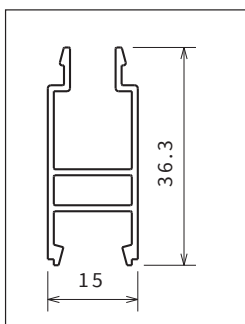

compensativi
R-2A-G+FL-3P-3PH-G-B-S-2P-2PH-A-AH

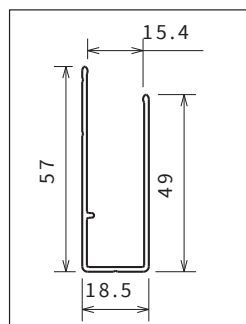

compensativi
R-2A-2P-2PH-A-AH

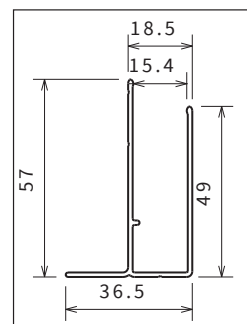

compensativi
G+FL-3PH-3P-S-B-G

Finitura	Codice
Bianco	P01BJMOST-A
Silver	P01BJMOST-B
Cromo	P01BJMOST-K
Argento	P01BJMOST-J

Finitura	Codice
Bianco	P01BJBST-A
Silver	P01BJBST-B
Cromo	P01BJBST-K
Argento	P01BJBST-J

Finitura	Codice
Bianco	P05HAAST3-A
Silver	P05HAAST3-B
Cromo	P05HAAST3-K
Argento	P05HAAST3-J

Finitura	Codice
Bianco	P05BHST-A
Silver	P05BHST-B
Cromo	P05BHST-K
Argento	P05BHST-J

Finitura	Codice
Bianco	P05BHMOST-A
Silver	P05BHMOST-B
Cromo	P05BHMOST-K
Argento	P05BHMOST-J

COME RILEVARE LE MISURE

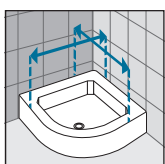
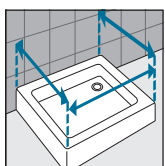
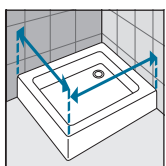

Rilevare le misure da muro a bordo esterno del piatto doccia. Le misure devono essere rilevate sulla parete finita, a rivestimenti posati, secondo gli schemi riportati.

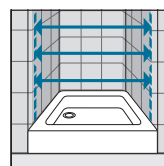

Rilevare le misure da muro in basso, in alto, al centro e utilizzare quella di valore inferiore. Le misure devono essere rilevate sulla parete finita, a rivestimenti posati, secondo gli schemi riportati.